

TERMINATION OF FLASHING
WILL VARY

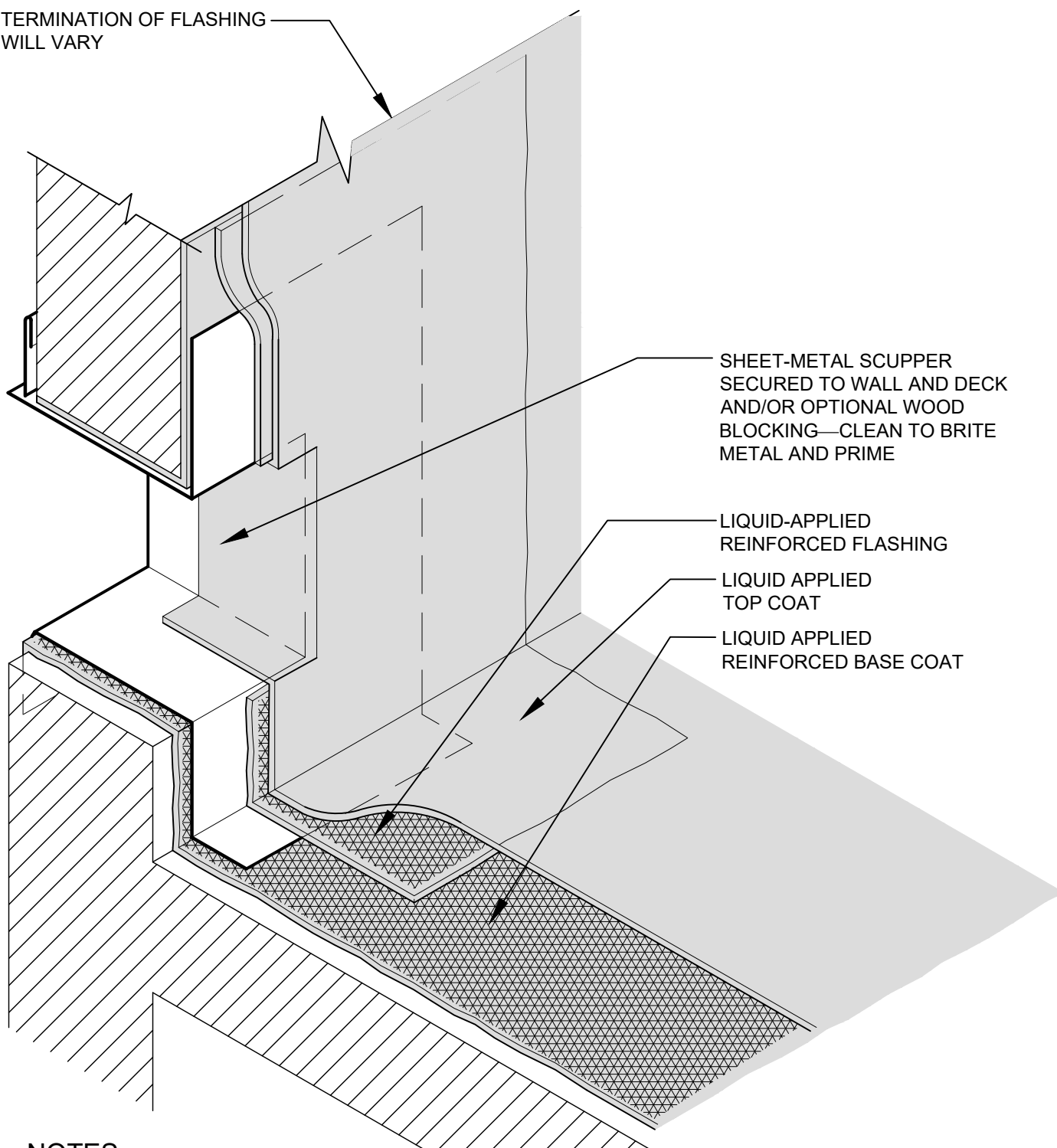

NOTES

1. THIS DETAIL DOES NOT ALLOW FOR DIFFERENTIAL MOVEMENT BETWEEN THE DECK AND WALL.
2. ELEVATION OF SCUPPER MAY VARY.
3. PRIMING OF THE SUBSTRATE MAY BE REQUIRED. FOLLOW SPECIFICATIONS AND MANUFACTURER'S RECOMMENDATIONS.



SHEET TITLE:
BASE FLASHING AT OVERFLOW
SCUPPER IN FULLY REINFORCED
RESTORATION OVER CONCRETE

SCALE:
NTS

DRAWING No.:
DWG NO. LA-CFR-26