

NOTE: REFER TO TREMCO'S PUBLISHED APPLICATION INSTRUCTIONS FOR ACCEPTABLE JOINT SIDE WALL SUBSTRATE CONDITIONS PRIOR TO INSTALLATION

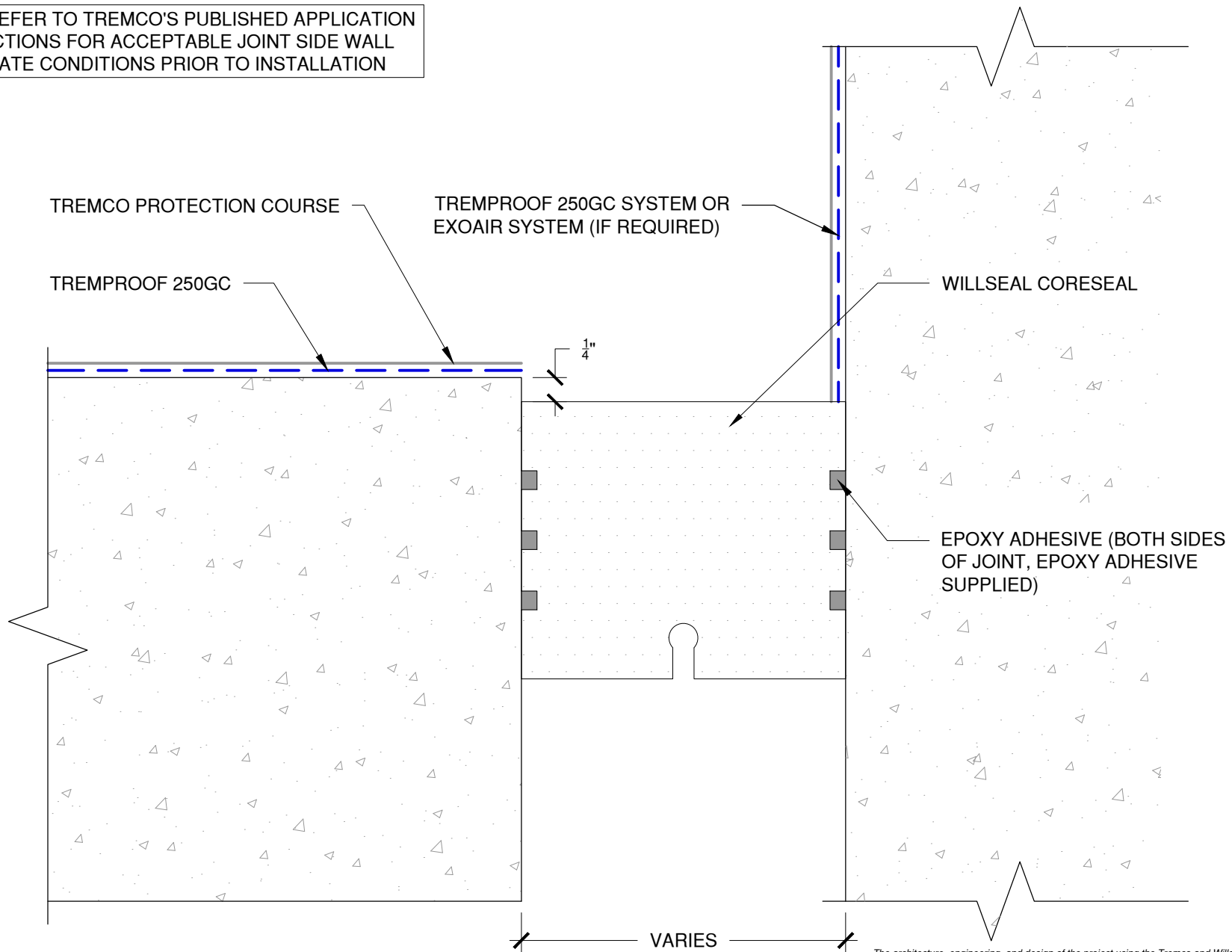

*The architecture, engineering, and design of the project using the Tremco and Willseal products are the responsibility of the project's design professional. All products and systems must comply with local building codes and standards. This detail is for general information and guidance only and Tremco and Willseal specifically disclaims any liability for the use of this detail. The project design professional determines, in its sole discretion, whether this detail or a functionally equivalent detail is best suited for the project. This detail is subject to change without notice. Contact Willseal or Tremco to ensure you have the most recent version.*

**Willseal Coreseal**

Detail: Willseal Coreseal with TREMproof 250GC at Floor to Wall Expansion Joint

File Name:

WC-FW-250-01

Drawn by: HDE

Checked by: AM/WH

Scale: NTS

Date: 2/23/2022



Willseal Technical Support: 800-274-2813

[www.tremcocpg.com](http://www.tremcocpg.com)



Construction Products Group