

TREMCO PROTECTION COURSE

TREMDRAIN, AS SPECIFIED

ELASTOMERIC SHEETING  
EMBEDDED IN TREMPROOF 6100

TREMPROOF 6100 WITH EMBEDDED  
REINFORCING FABRIC AS SPECIFIED

SUPERSTOP WATERSTOP

TREMDRAIN, AS SPECIFIED

APPROVED PARASEAL PRODUCT

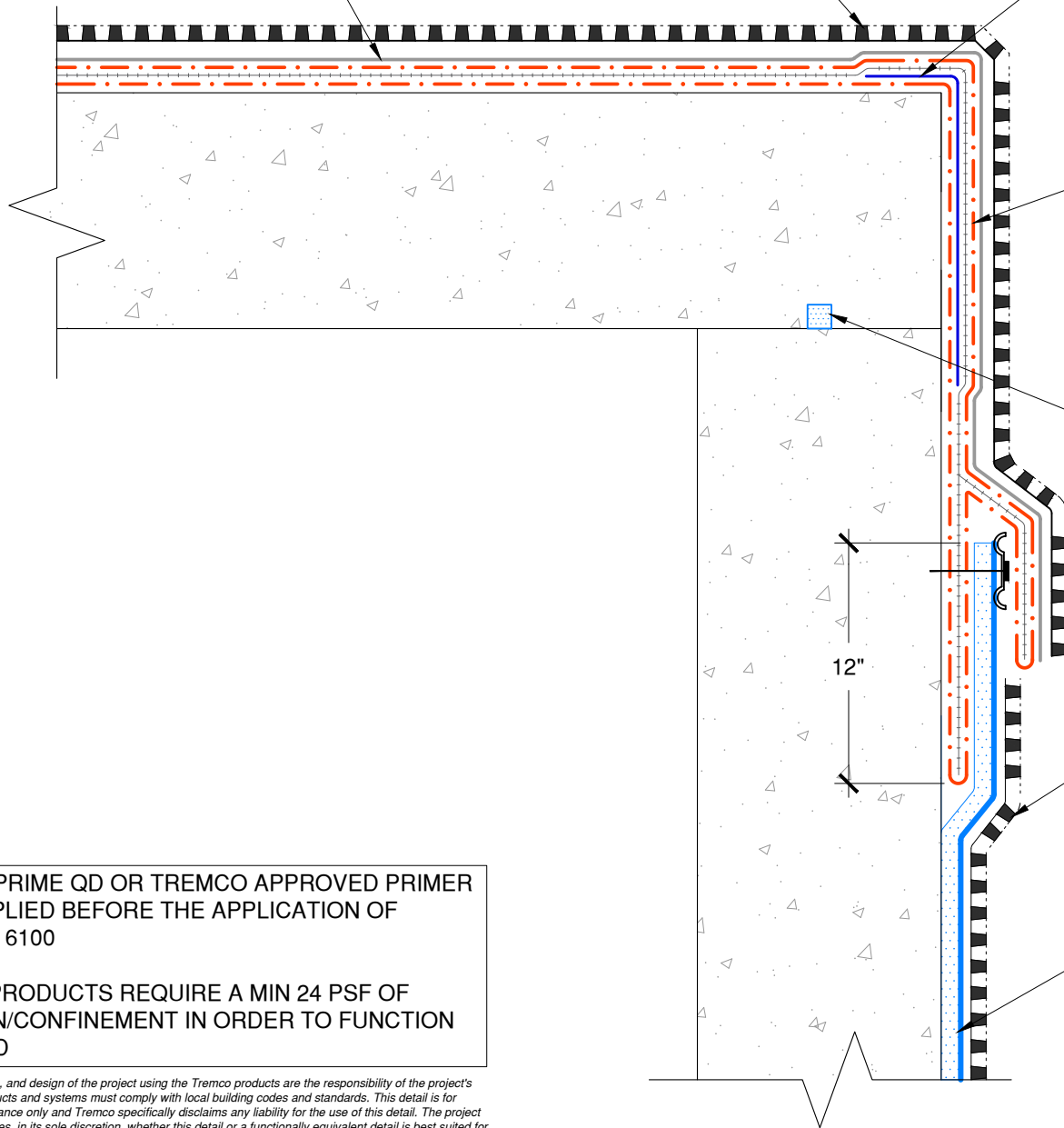

NOTE: TREMPRIME QD OR TREMCO APPROVED PRIMER  
MUST BE APPLIED BEFORE THE APPLICATION OF  
TREMPROOF 6100

PARASEAL PRODUCTS REQUIRE A MIN 24 PSF OF  
COMPACTION/CONFINEMENT IN ORDER TO FUNCTION  
AS DESIGNED

The architecture, engineering, and design of the project using the Tremco products are the responsibility of the project's design professional. All products and systems must comply with local building codes and standards. This detail is for general information and guidance only and Tremco specifically disclaims any liability for the use of this detail. The project design professional determines, in its sole discretion, whether this detail or a functionally equivalent detail is best suited for the project. This detail is subject to change without notice. Contact Tremco to ensure you have the most recent version.

**TREMPROOF 6100**

Detail: TREMPROOF 6100 to Paraseal at Deck to Wall Transition

File Name:

H-T-02

Drawn by: KAB

Checked by: WH

Scale: NTS

Date: 3/8/2022



Tremco Technical Support: 866-209-2404

[www.tremcocpg.com](http://www.tremcocpg.com)



Construction Products Group