

FACTORY APPLIED AND CURED SILICONE

HEAVY DUTY COVER PLATE WITH SLIP-RESISTANT SERRATED PROFILE, IMPACT/SOUND DAMPER, AND ANTI-VIBRATION SEAL

WILLSEAL MODIFIED ACRYLIC IMPREGNATED MICROCELL FOAM

FIELD APPLIED SILICONE SEALANT (BOTH SIDES OF JOINT)

SILICONE SEALANT SUPPLIED

TREMPROOF 201/60/250GC VERIFY COMPATIBILITY IN FIELD

FIELD APPLIED EPOXY (BOTH SIDES OF JOINT) EPOXY SUPPLIED

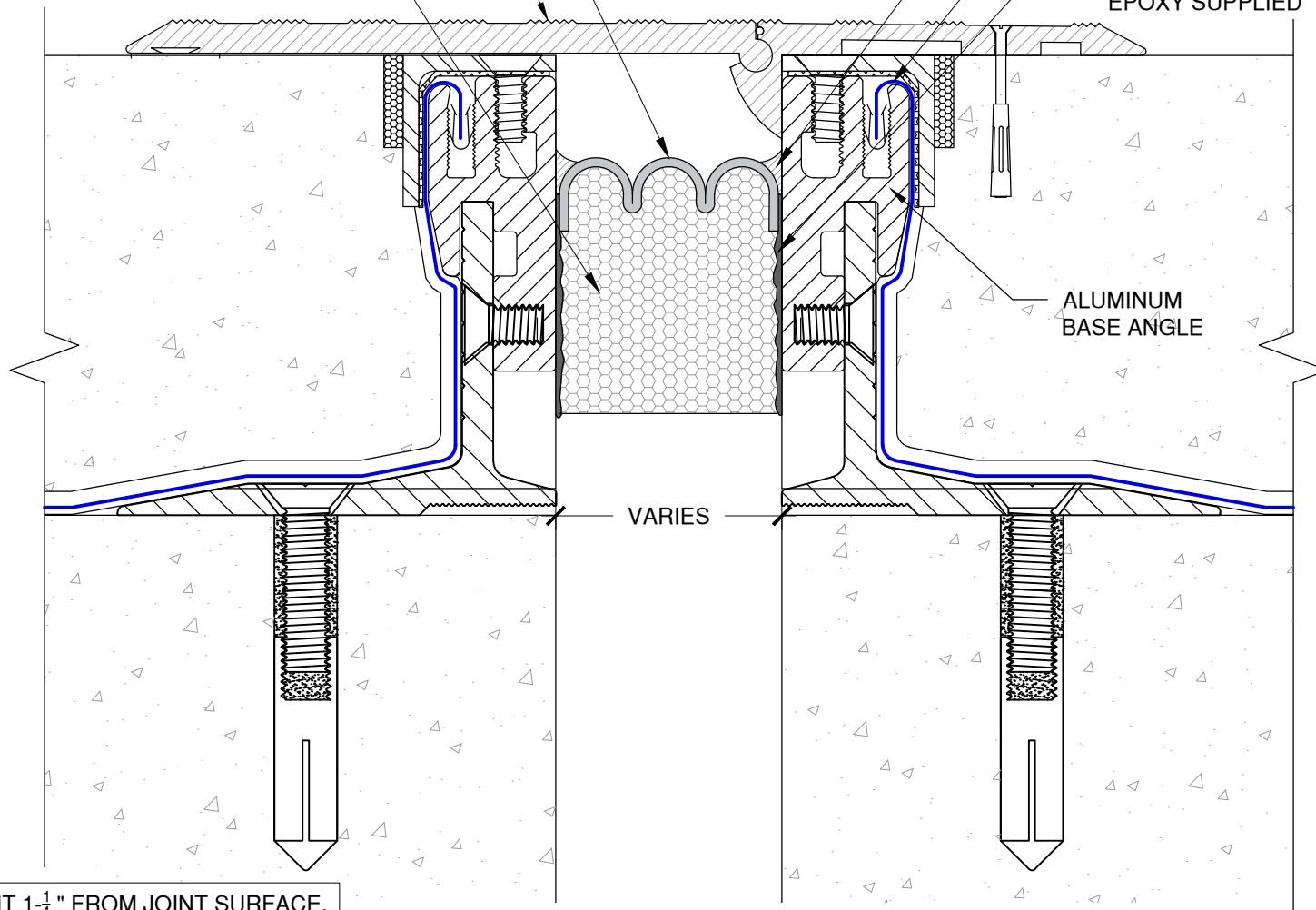

NOTES: RECESS JOINT 1- $\frac{1}{4}$ " FROM JOINT SURFACE.

FOR COVER PLATE INSTALLATION, SEE SUPPLIED INSTRUCTIONS.

The architecture, engineering, and design of the project using the Willseal products are the responsibility of the project's design professional. All products and systems must comply with local building codes and standards. This detail is for general information and guidance only and Willseal specifically disclaims any liability for the use of this detail. The project design professional determines, in its sole discretion, whether this detail or a functionally equivalent detail is best suited for the project. This detail is subject to change without notice. Contact Willseal to ensure you have the most recent version.

Willseal 250

Detail: Willseal 250 with Tremco Waterproofing at Split Slab Application with Heavy Duty Cover Plate

File Name:

W250-FF-CP-04

Drawn by: HDE

Checked by: AM/WH

Scale: NTS

Date: 7/19/2022



Willseal Technical Support: 800-274-2813

www.tremcocpg.com



Construction Products Group