

PERMANENT SEAM TAPE AT ALL VERTICAL SEAMS (INTERRUPTED IN DRAWING FOR CLARITY)

CORNER NAILS SHOULD BE WITHIN 3" MAX. OF CORNER AND STAGGERED

FULL SHEET OF PARASEAL WITH HDPE SIDE FACING INSTALLER, CENTERED AT CORNER

1" CONTINUOUS VERTICAL CANT OF DYMONIC 100 AT CORNER UNDER PARASEAL MEMBRANE

2" PARAGRANULAR CANT AT WALL FOOTING UNDER PARASEAL MEMBRANE

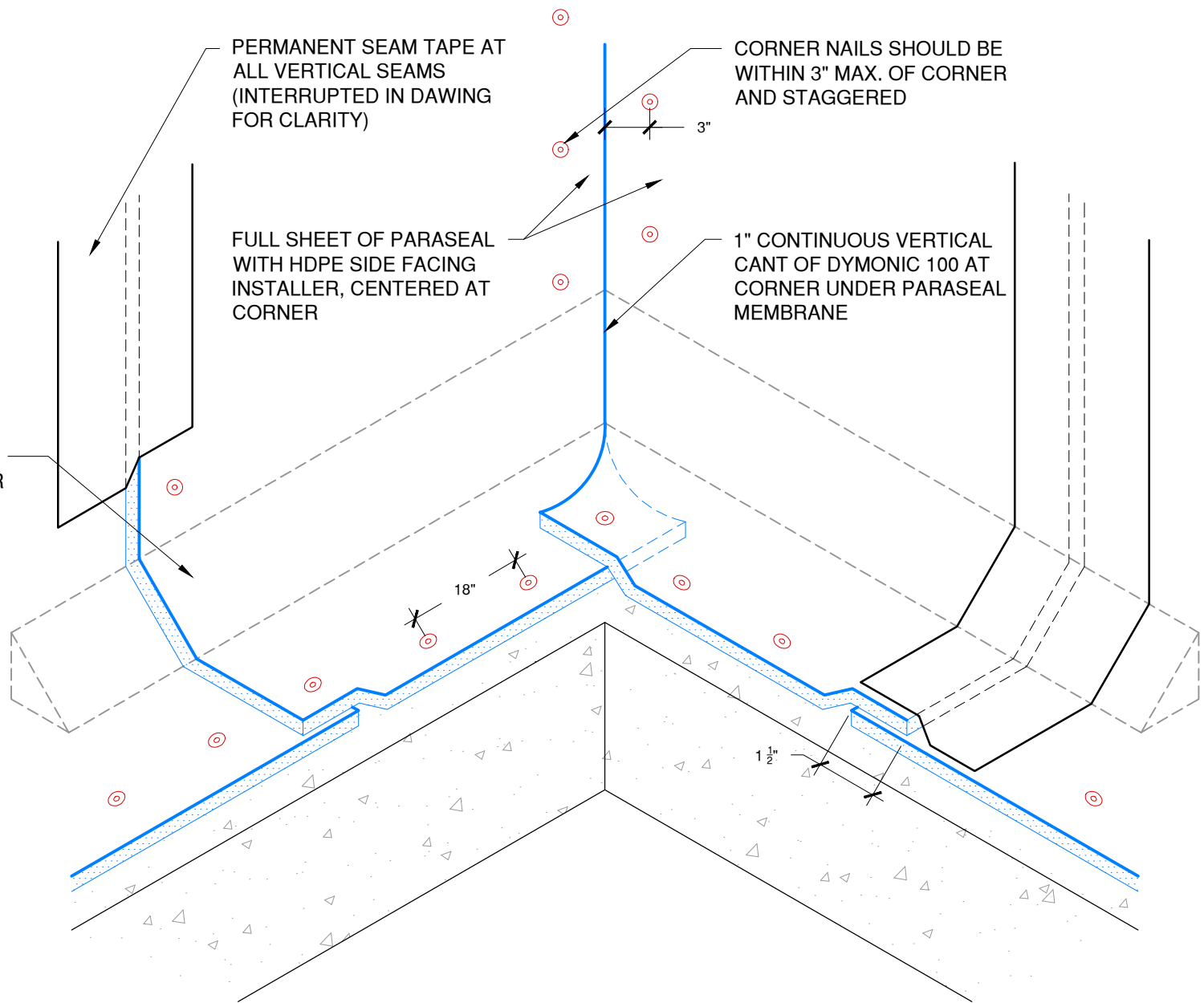

NOTE: PARASEAL PRODUCTS REQUIRE A MIN 24 PSF OF COMPACTION/CONFINEMENT IN ORDER TO FUNCTION AS DESIGNED

The architecture, engineering, and design of the project using the Tremco products are the responsibility of the project's design professional. All products and systems must comply with local building codes and standards. This detail is for general information and guidance only and Tremco specifically disclaims any liability for the use of this detail. The project design professional determines, in its sole discretion, whether this detail or a functionally equivalent detail is best suited for the project. This detail is subject to change without notice. Contact Tremco to ensure you have the most recent version.

Paraseal Backfilled Walls



Detail: Paraseal Installation at Inside Corners				File Name:
Drawn by: KAB	Checked by: WH	Scale: NTS	Date: 2/23/2022	BFW-P-C-02
www.tremcocpg.com				

