

VULKEM 346 OR 951NF  
TOP COAT

VULKEM 346, 950NF 951NF  
OR VULKEM EPOXY WC  
INTERMEDIATE COAT  
W/AGGREGATE

VULKEM 350NF, 350FC OR  
360NF BASE COAT

TREMCO PUMA TC

TREMCO PUMA WC, SEEDED TO  
REFUSAL WITH AGGREGATE

TREMCO PUMA BC

TREMCO PUMA PRIMER

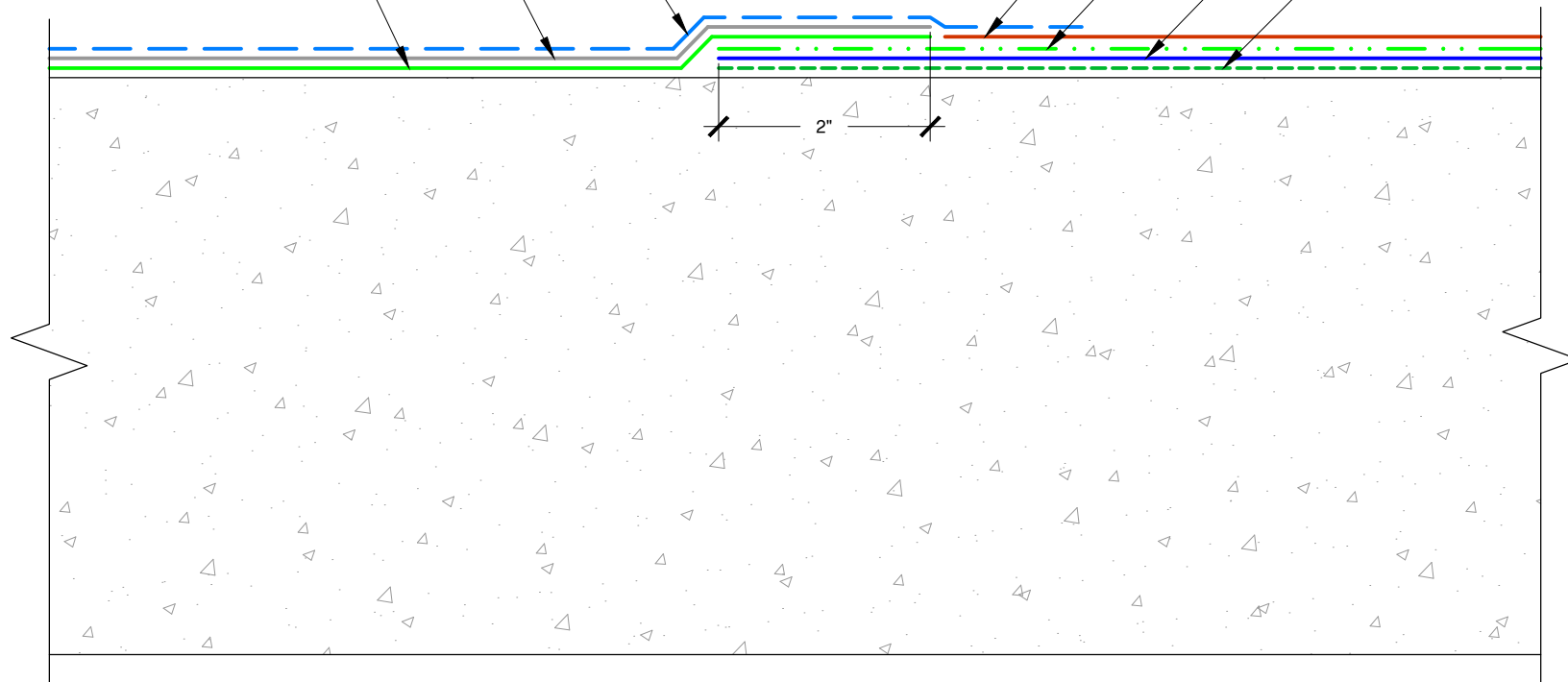

\*A COMPONENT OF THE VULKEM® EWS TRAFFIC COATING SYSTEM WITH PUMA (POLYURETHANE METHACRYLATE)

NOTE: VULKEM 950 NF MAY BE USED AS TOPCOAT IN AREAS WITH NO U.V.

VULKEM EPOXY WC MUST NOT BE USED WITH VULKEM 350FC

*The architecture, engineering, and design of the project using the Tremco products are the responsibility of the project's design professional. All products and systems must comply with local building codes and standards. This detail is for general information and guidance only and Tremco specifically disclaims any liability for the use of this detail. The project design professional determines, in its sole discretion, whether this detail or a functionally equivalent detail is best suited for the project. This detail is subject to change without notice. Contact Tremco to ensure you have the most recent version.*

### Vulkem Vehicular Coating



www.tremcosealants.com  
Tremco Technical Support: 866-209-2404

Detail: Vulkem Deck Coating System to Vulkem EWS Connection

Drawn by: KAB

Checked by: WH

Scale: NTS

Date: 10/20/2021

File Name:

DC-T-01



Construction Products Group

Tremco Construction Products Group companies: Dryvit Systems, Inc.; Nudura Inc.; Prebuck LLC; Schul International Co., LLC d/b/a/ Willseal; Tremco Incorporated